

# DATA SHEET

## Flanged Ball Valves PROKOSCH Model 400



PROKOSCH ball valves are suitable for use with granulated, pulverized media as well as neutral liquids, suspensions and gases. They are characterised by the use of fewer individual parts, space-saving elements as well as easy operation and a long service life.

The full bore trunnion mounted ball reduces flow resistance and wear to the ball and seats to a minimum and provides a low switching torque over the entire pressure range.

Thanks to their modular design, PROKOSCH ball valves are easy to configure and our standard designs and options have been proven in a wide range of applications. Since the ball valve does not have any ignition source, it can also be configured for safe use in various ATEX applications.

### Specifications

Pressure rating	PN16
Nominal diameter	DN50...DN200
Min. Temperature <sup>1)</sup>	-15 °C / -20 °C / -40 °C
Max. Temperature <sup>2), 3)</sup>	+80 °C / +180 °C / 230 °C
Upstream connection	PN16 Flange DIN 1092-1
Downstream connecton	PN16 Flange DIN 1092-1

### Material Selection

Body	cast iron (primed) / aluminium / stainless-steel
Ball	cast iron <sup>5)</sup> / aluminium / stainless-steel
Seats	PTFE / E-PTFE / UHMWPE / stainless-steel
O-Rings	NBR / FKM / Silicone (FEP coated)

### Seat Selection

PROKOSCH PTFE O-Ring tensioned	solids, suspensions and liquids
PROKOSCH UHMWPE O-Ring tensioned	more abrasive solids and suspensions
PROKOSCH Metall-O-Ring tensioned	abrasive and adhesive solids, media tight
PROKOSCH special casing	gases and liquids, reinforced for high flow rates
PROKOSCH non-clogging <sup>4)</sup>	seated upstream with open downstream, media tight

### Recommended Application

### Dimensions

													Weights (kg) by MK			
DN	PN	LW	L	D	K	d	i	-	-	H	R	SW	5	3,4	8,9	Rest
<input type="checkbox"/> 50 (2")	16	50	144	165	125	18	4	-	-	130	250	17	3,8	4,5	4,5	9,3
<input type="checkbox"/> 65 (2½")	16	64	163	185	145	18	4	-	-	140	270	19	-	7,5	8,0	13,7
<input type="checkbox"/> 80 (3")	16	78	180	200	160	18	8	-	-	150	270	19	-	9,0	9,5	17,0
<input type="checkbox"/> 100 (4")	16	97	200	220	180	18	8	-	-	175	330	27	-	14,2	16,0	28,5
<input type="checkbox"/> 125 (5")	16	122	200	250	210	18	8	-	-	200	300*	27	-	26,5	27,5	42,0
<input type="checkbox"/> 150 (6")	16	150	350	285	240	22	8	-	-	250	600	35	-	43,3	44,3	81,5
<input type="checkbox"/> 200 (8")	16	200	400	340	295	22	8	-	-	290	600	35	-	-	-	140,0**

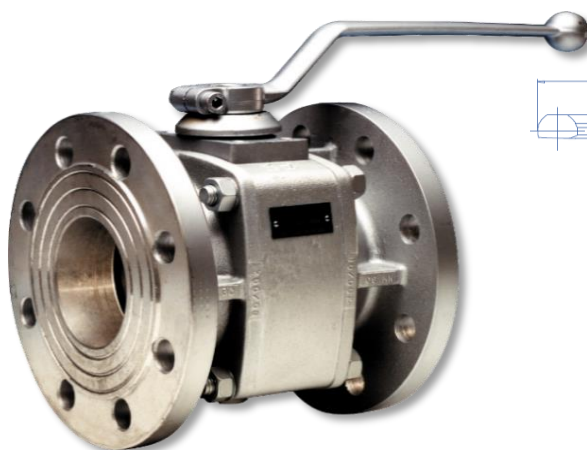
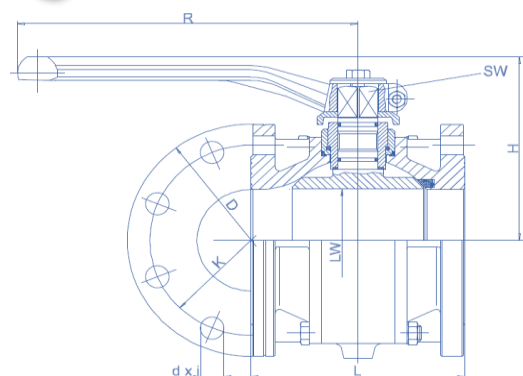

Illustration with option /FA





# DATA SHEET

## Flanged Ball Valves PROKOSCH Model 400

Product configuration - most applications are covered by our standard designs. The standard design can be supplemented with a selection of options to suit the application. In addition, we can offer customised special designs for more demanding requirements.

All ball valves are manufactured in our factory in Germany. Our trained employees and our ISO9001 certified quality management system ensure the high and consistent quality of our products. Furthermore, factory certificates according to EN 10204 2.2 and 3.1 are available on request.

PROKOSCH model 400 ball valves are typically used in the process industry for conveying neutral, flammable liquids and suspensions as well as for granulated and powdered media.

Design				Code	
<i>Housing</i>	<i>Ball</i>	<i>Seat/O-Rings</i>	<i>Seat Type</i>	<i>MK</i>	
Cast iron	Cast iron <sup>5)</sup>	PTFE/FKM	Special casing	1	<input type="radio"/>
Cast iron	Cast iron <sup>5)</sup>	PTFE/NBR	O-Ring tensioned	2	<input type="radio"/>
Aluminium	Cast iron <sup>5)</sup>	PTFE/FKM	Special casing	3	<input type="radio"/>
Aluminium	Cast iron <sup>5)</sup>	PTFE/NBR	O-Ring tensioned	4	<input type="radio"/>
Aluminium	Aluminium <sup>6)</sup>	PTFE/NBR	O-Ring tensioned	5	<input type="radio"/>
Cast iron	Stainless-st.	PTFE/FKM	Special casing	6	<input type="radio"/>
Cast iron	Stainless-st.	PTFE/NBR	O-Ring tensioned	7	<input type="radio"/>
Aluminium	Stainless-st.	PTFE/FKM	Special casing	8	<input type="radio"/>
Aluminium	Stainless-st.	PTFE/NBR	O-Ring tensioned	9	<input type="radio"/>
Cast iron	Stainless-st. <sup>7)</sup>	Stainless-st. <sup>7)</sup>	Metal O-Ring tensioned	10	<input type="radio"/>
Top Mounting				Code	
Standard, with stop washer and hand lever				-	<input type="radio"/>
Bare shaft, with stop washer				/OH	<input type="radio"/>
Bare shaft with top flange prepared for actuator adaptation				/SO	<input type="radio"/>
Options				Code	
Anti clogging design, seated only upstream with aerodynamic open downstream				/FA	<input type="checkbox"/>
Flushing port, a 1/2" threaded hole for flushing on one side of the ball valve				/SB	<input type="checkbox"/>
Anti-static-device, enabling the dissipation and inhibition of electrostatic buildup				/AS	<input type="checkbox"/>
Lock-out-device, a valve can be locked in place by a mechanical locking device				/LO	<input type="checkbox"/>
E-PTFE seats, for increased conductivity for anti-static applications				(E-PTFE)	<input type="checkbox"/>
UHMWPE seats, alternative to PTFE seats for increased wear resistance				(UHMWPE)	<input type="checkbox"/>
FKM o-rings, alternative to NBR o-rings of a standard design				-FKM	<input type="checkbox"/>
FEP o-rings, alternative to the o-rings of a standard design				-FEP	<input type="checkbox"/>
Protective coating in addition to priming the cast iron bodied valves				-RAL#	<input type="checkbox"/>

Note:  single selection,  multiple selection

Order Code: <Model>/<Nominal Diameter>/<Design> <Top Mounting> <Options>

Examples: 400/65/4/FA/SB, or 400/100/9/SO/FA/AS (E-PTFE) -RAL5019

1) NBR O-Rings -20°C, FKM O-Rings -15°C, Low temperature application -40°C with Silicone(FEP) O-Rings; 2) Higher temperature range +180°C with PTFE Seats and FKM O-Rings; 3) High temperature applications 230°C only with stainless-steel seats and FKM O-Rings; 4) The /FA anti-clogging design is available for all O-Ring tensioned seat types; 5) hard chrome plated and polished; 6) Aluminium balls available for DN40 and DN50 other sizes upon request; 7) borated for increased wear resistance, the seats are fitted with FKM O-Rings; \*) DN125 optionally available with 600mm hand lever. \*\*) DN200 available in Designs 1,2,6,7 and 10 as also in stainless steel.



**PROKOSCH Pumpen und Armaturen GmbH**

In der Breitwiese 9, DE-76684 Östringen, Germany  
Phone +49 7259 9103 0 - Telefax +49 7259 9103 49  
contact us at [www.prokosch.de](http://www.prokosch.de) - [sales@prokosch.de](mailto:sales@prokosch.de)