



PROKontrol manual override gear boxes are used with pneumatically actuated PROKOSCH ball valves. The manual override gearbox is fitted between the valve mounting bracket and the actuator.

The manual override gear box includes a switch to enable the override. In automatic operation the switch must be set such that the manual override is disabled.

Specifications

Mounting	perpendicular to valve
Application	single and double acting
Actuator and Valve mounting interface	ISO 5211
Temperature range	-15...+120 °C
Protection class	IP67
Torque output max. / connection wrench size	
- PROKontrol Part No. HNG17 (DN40/50/65 Ball Valves)	250Nm / 17mm
- PROKontrol Part No. HNG22 (DN65/80/100 Ball Valves)	500Nm / 22mm
- PROKontrol Part No. HNG27 (DN100/125 Ball Valves)	1000Nm / 27mm
- PROKontrol Part No. HNG36 (DN150 Ball Valves)	2000Nm / 36mm

Materials

Cap (1)	Aluminium alloy, for HNB36 ductile iron
Body (2)	Aluminium alloy, for HNB36 ductile iron
Adjustment screw (3)	Carbon steel
Worm gear (4)	Ductile iron
Worm (5)	Carbon steel / ductile iron
Switch handle (6), Gland (7), Hand wheel (8)	Carbon steel

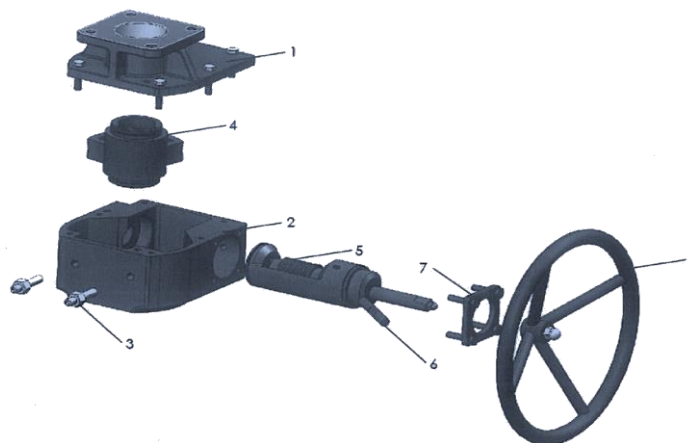

Other gear boxes are available on request. PROKontrol automation components are typically available on stock at PROKOSCH. Other customer specific automation components are purchased on demand.



PROKOSCH Pumpen und Armaturen GmbH

In der Breitwiese 9, DE-76684 Östringen, Germany
 Phone +49 7259 9103 0 - Telefax +49 7259 9103 49
 contact us at www.prokosch.de - sales@prokosch.de